



CONCRETE SIDEWALK

STD. NO.	DATE
403.1	10-19-07
SHEET 1 OF 2	

CITY OF MORGANTON

NOTES:

CONSTRUCT STANDARD SIDEWALK 5' WIDE AND 4" THICK UNLESS OTHERWISE DENOTED ON PLANS. CONCRETE SHALL HAVE A COMPRESSIVE STRENGTH OF 4000 PSI AT 28 DAYS.

SIDEWALKS THAT CROSS DRIVEWAY ENTRANCES SHALL BE 6" THICK FOR THE LENGTH OF THE DRIVEWAY CROSSING.

PLACE A GROOVE JOINT 1" DEEP WITH 1/8" RADII IN THE CONCRETE SIDEWALK AT 5' INTERVALS. ONE 1/2" EXPANSION JOINT WILL BE REQUIRED AT 50' INTERVALS. A 1/2" EXPANSION JOINT WILL BE REQUIRED WHERE THE SIDEWALK JOINS ANY RIGID STRUCTURE.

SEE STD. DWG. 400.1 & 400.2 FOR WHEELCHAIR RAMP LOCATION REQUIREMENTS AND CONSTRUCTION GUIDELINES.

NOT TO SCALE

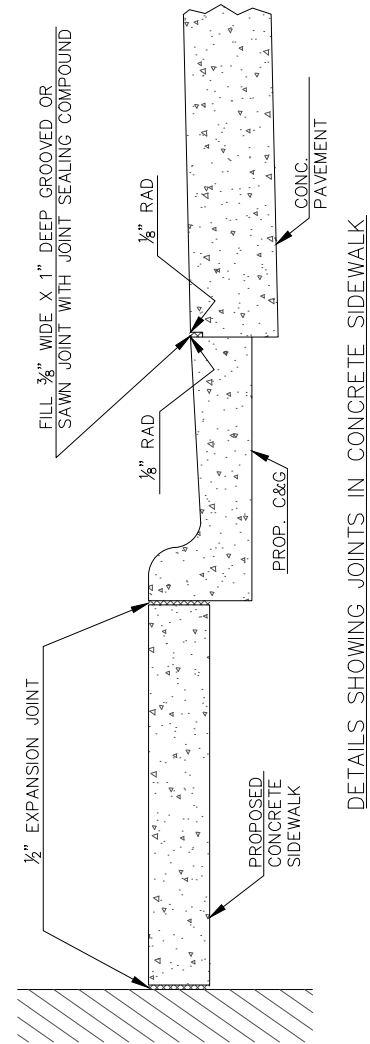
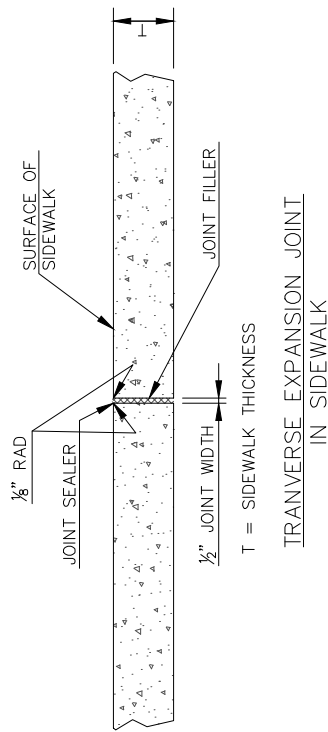
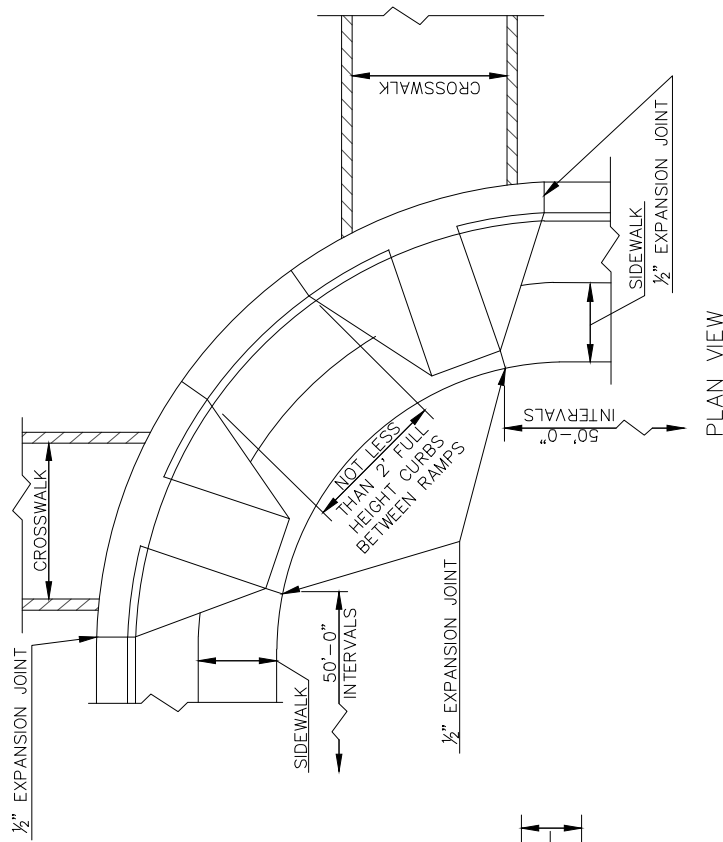

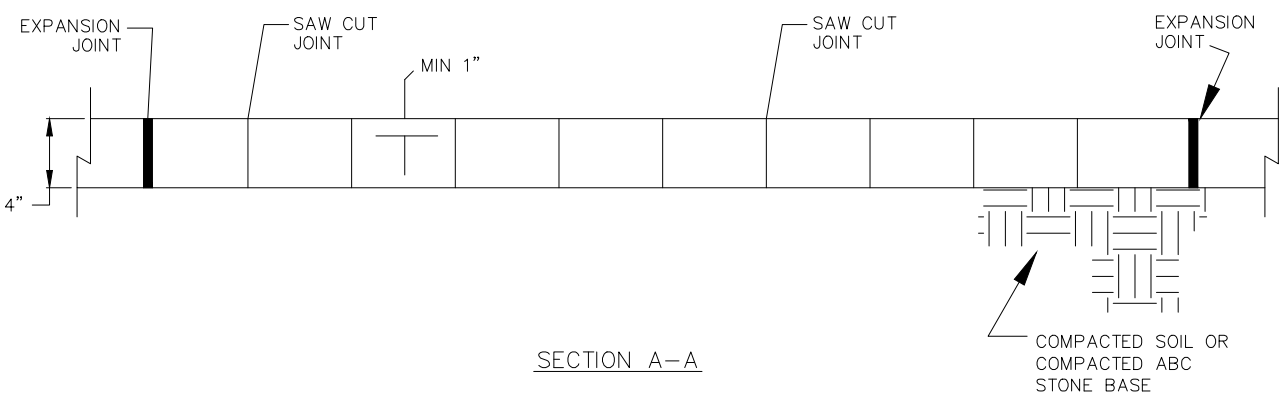
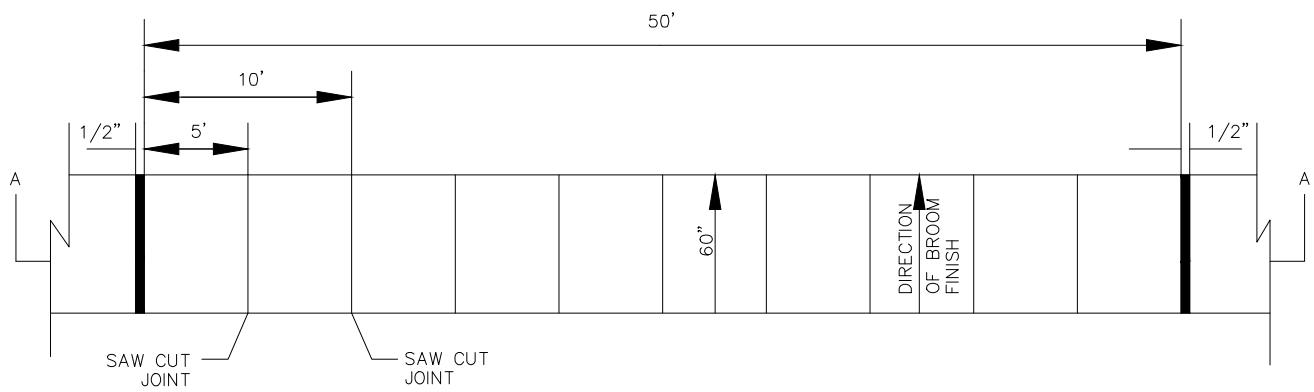

SECTION A-A

- NOTE:
1. CONCRETE SHALL HAVE A COMPRESSIVE STRENGTH OF 4000 PSI AT 28 DAYS.
 2. SIDEWALK SAW CUT JOINTS ARE TYPICAL AND SHALL BE FIELD VERIFIED.
 3. SURFACE SHALL BE ROUGH NON-SKID TYPE.
 4. ALL SIDEWALKS SHALL HAVE CROSS-SLOPE OF 1/4" PER FOOT TO DRAIN TOWARD STREET.
 5. SIDEWALKS AT DRIVEWAY CUTS/ENTRANCES SHALL BE MINIMUM 6" THICK CONCRETE.

NOT TO SCALE



CONCRETE SIDEWALK

STD. NO.

403.2

DATE

10-19-07
SHEET 2 OF 2

CITY OF MORGANTON